



Practical solutions for
installation in commercial vehicles

PEUGEOT

Expert · Partner · Boxer



**Van racking systems
in 100% aluminium**

System ALUCA Package deal

for **Peugeot Commercial Vehicles** – the practical solutions in **100% aluminium** for installation in Service vehicles in different sectors.

START

The service package for **PEUGEOT Partner**
From model year 08, wheelbase 2728 mm
From model year 08, wheelbase 2728L mm
and **PEUGEOT Expert**
From model year 07, wheelbase 3000 mm

Module left: W 765 x H 950 x D 250/320 mm

Module right: W 1255 x H 950 x D 250/320 mm

Weight: 33 kg



BASIC

The service package for **PEUGEOT Partner**
From model year 08, wheelbase 2728 mm
From model year 08, wheelbase 2728L mm
and **PEUGEOT Expert**
From model year 07, wheelbase 3000 mm

Module left: W 765 x H 850 x D 250/320 mm

Module right: W 1255 x H 950 x D 250/320 mm

Weight: 44 kg



STANDARD

The service package for **PEUGEOT Expert**
From model year 07, wheelbase 3122 mm
and **PEUGEOT Boxer**
From model year 06, wheelbase 3000 mm H1
From model year 06, wheelbase 3450 mm H1

Module left: B 1185 x H 950 x T 420 mm

Module right: B 1990 x H 1050 x T 320 mm

Weight: 74 kg



Rotated drawer element

PLUS

The service package for **PEUGEOT Boxer**

From model year 06, wheelbase 3450 mm H1
From model year 06, wheelbase 4035 mm H2

Module left: B 1500 x H 1050 x T 420 mm

Module right: B 2480 x H 1050 x T 420 mm

Weight: 101 kg

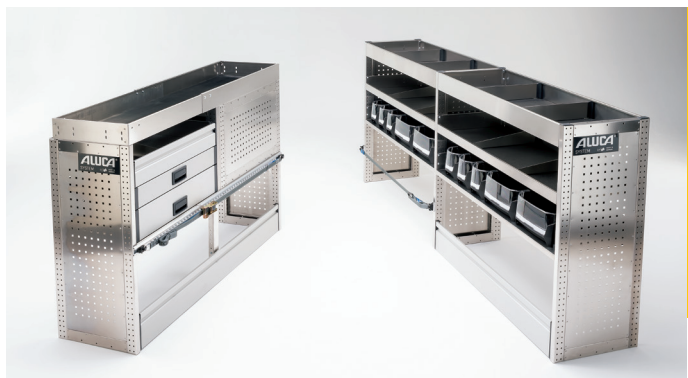

Rotated drawer element

Rotated drawer element:

Easily operated through the sliding sidedoor at the passenger side.



- All modules delivered fully assembled
- Delivery includes floor and sidewall mounting kit

Accessories for Peugeot Commercial vehicles

Side wall protection

in perforated aluminium plating

- For protection of the vehicle side wall at loading and unloading
- The perforated side wall protection can be used as tool and accessory holder



Accessories for Service package

STANDARD and PLUS:

Pull-out worktop with 360° turnable vice

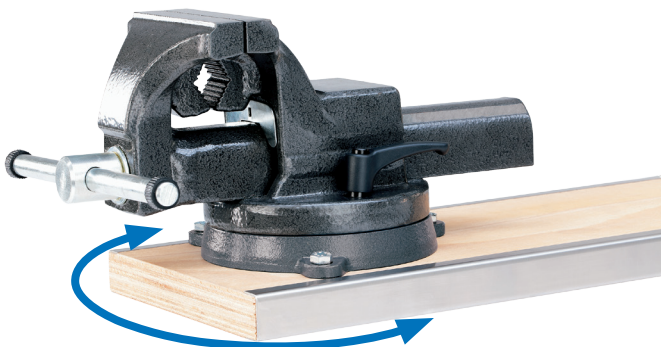

Base plate

with aluminium entry profiles

- The aluminium entry profiles increases product durability
- Can be combined with rigging rail and lashing points
- ALUCA-covers use of the original lashing points

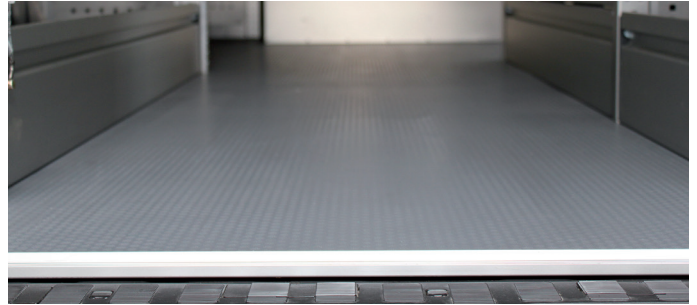

Model*	Year [from]	Wheelbase [mm]	Weight [kg]
Partner	08	2728	17
Partner long	08	2728L	18
Expert	07	3000	25
Expert long	07	3122	30
Boxer	06	3000	35
Boxer middle	06	3450	42
Boxer long	06	4035	47

*vehicle with sliding door at the right.
Many other modules on request.

ALUCA dimension2

The innovative underfloor system

for **Bipper**, **Expert** and **Partner**

– Designed to measure



- The second floor has the same loadcapacity as the regular floor [up to 700 kg of weight]
- Ergonomical loading and unloading of the drawers
- Drawers with full pull-out
- Can be combined with rigging rail and lashing points

Accessories



Lashing rail

Aluminium, 990 mm,
Part. Nr. 100963
Aluminium, 1490 mm,
Part. Nr. 100964



Lashing point

Aluminium
Part. Nr. 106153



Lashing strap

with ratchet, 1 m
Part. Nr. 100979
with ratchet, 2 m
Part. Nr. 100980



Tensioning strap

with clamp buckle, 1 m
Part. Nr. 100982
with clamp buckle, 2 m
Part. Nr. 100983



Tension lock

in zinc-plated steel
long rubber strap
90 mm
Part. Nr. 100893

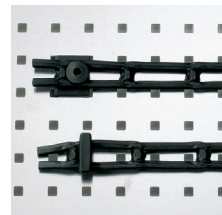

Rubber load restraint

30 mm width, with 2
mounting buttons, 1 m
Part. Nr. 100985



Hose holder in Aluminium

Hose holder SH25
width 250 mm
Part. Nr. 105614
Hose holder SH32
width 320 mm
Part. Nr. 105616



Tool holder

Tool holder 20 - 30 mm
Part. Nr. 101048
Tool holder 30 - 40 mm
Part. Nr. 101049
Rall 500 mm
Part. Nr. 101050
Rall 900 mm
Part. Nr. 101051



Load cargo net

1200 x 1800 mm
with all-round belt
incl. ratchet lock to
lash down loads
Part. Nr. 101014



Telescopic locking rod

Aluminium
Lenght 1250-1750 mm
Part. Nr. 103512
Lenght 1550-2050 mm
Part. Nr. 103153



Aluminium box with insert bins

Fig. 1
Part. Nr. 100921
Fig. 2
Part. Nr. 100922
Fig. 3
Part. Nr. 100923

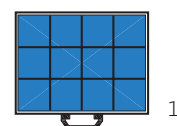

1

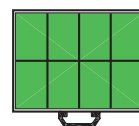

2

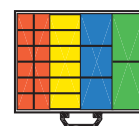

3



Battery - hand light

Work- and Emergency
light explosion
protected, inkl. Charging
station and holder
Part. Nr. 102950



LED-Lights

24 Power-LEDs, 8 Watt
with on/off switch
Part. Nr. 104904



Towel dispenser with disposable paper towels

Art. Nr. 100938
9 replacement rolls
Part. Nr. 100939



Cleaning cloths

Contains 50 towels
Part. Nr. 100943
Holder for dispenser
box
Part. Nr. 100945



Storage box

Aluminium,
with 2 compartments
Part. Nr. 100895



Fire extinguisher 2 kg

incl. holder
ABC-extinguishing
powder
Part. Nr. 100912

Further accessories you will find in
our main catalogue at
www.aluca.de

Delivery ex works, all prices are our recommended retail prices, excl VAT
recommended retail prices. Our general terms and conditions apply, we
reserve the right for technical changes. Obligation free quote.

ALUCA®

ALUCA GmbH · Westring 1
74538 Rosengarten · Germany
Tel. +49 791 950 40-0
Fax +49 791 950 40-20
info@aluca.de · www.aluca.de